



WIMPOLE MEWS, MARYLEBONE, W1G
£1,750,000

Carter Jonas

WIMPOLE MEWS, MARYLEBONE, W1G

This well presented mews house, offering over 900 sq. ft. of thoughtfully arranged accommodation, creating a bright and inviting home.

The first floor features two generous double bedrooms, both with excellent natural light, accompanied by two modern bathrooms, providing comfortable and practical living space.

The top floor is dedicated to the main living areas, comprising a contemporary eat-in kitchen and a spacious reception room that opens onto a private balcony, perfect for outdoor dining.

Wimpole Mews is a highly sought after address, tucked between Weymouth Street and New Cavendish Street, just moments from the boutiques, cafés, and restaurants of Marylebone High Street. Its quiet, village like setting paired with superb proximity to central amenities makes it an exceptional Marylebone location.

- Heating: Mains Gas
- Broadband speeds can be checked here: checker.ofcom.org.uk.
- Mobile phone coverage and speeds can be checked here: checker.ofcom.org.uk, however, all providers are predicted to have good levels of service inside at this property.

AMENITIES

- Two bedroom Mews House
- Two bathrooms
- Spacious reception room with balcony
- Heating: Mains Gas
- Garage
- Service Charge - £545 approx per quarter.
- Buildings Insurance - £1,785 approx per annum.
- Ground Rent - Peppercorn

TENURE Leasehold – Expiry 19/09/2200

LOCAL AUTHORITY Westminster City Council (Band G)

EPC BAND D

A SUPERBLY PRESENTED TWO BEDROOM HOUSE WITH BALCONY, LOCATED ON A QUIET MEWS IN CENTRAL MARYLEBONE.





Wimpole Mews, W1G 8PD

Approx Gross Internal Area = 88.6 sq m / 954 sq ft

Garage = 13.2 sq m / 142 sq ft

Terrace = 4.6 sq m / 50 sq ft

Total = 106.4 sq m / 1146 sq ft

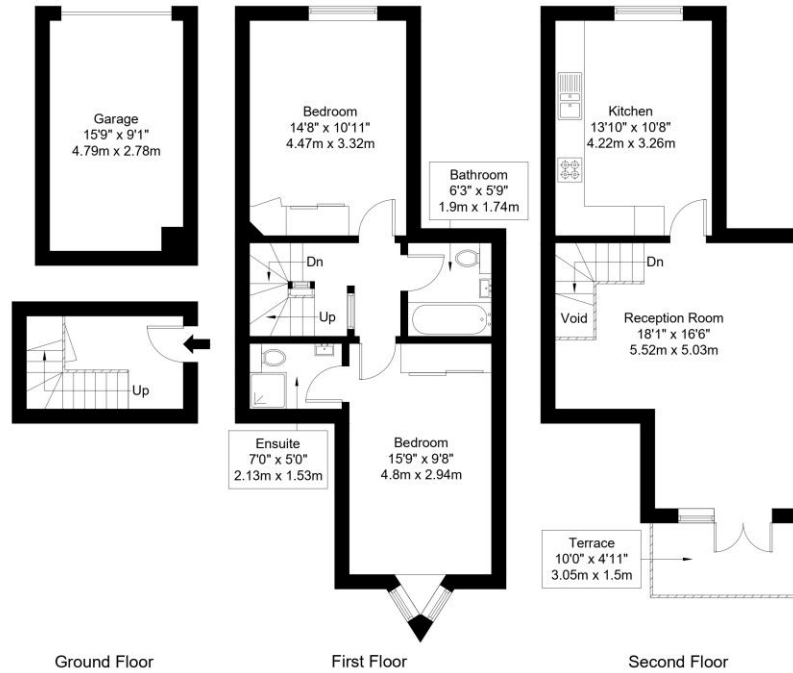

Ref :

Copyright **BLEU PLAN**

The Floor plan is not to scale and measurements and areas shown are approximate and therefore should be used for illustrative purposes only. The plan has been prepared in accordance with the RICS code of Measuring Practice and whilst we have confidence in the information produced it must not be relied on. Maximum lengths and widths are represented on the floor plan. If there is any aspect of particular importance, you should carry out or commission your own inspection of the property.
Copyright © BleuPlan

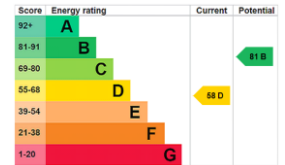

Mayfair 020 7493 0676

mayfair.sales@carterjonas.co.uk
18 Davies Street, Mayfair, London, W1K 3DS

carterjonas.co.uk
Offices throughout the UK

Exclusive UK affiliate of
CHRISTIE'S
INTERNATIONAL REAL ESTATE

IMPORTANT INFORMATION

These particulars are for general information purposes only and do not represent an offer or contract or part of one. Carter Jonas or anyone in their employment has made every attempt to ensure that the particulars and other information provided are as accurate as possible and they are not intended to amount to advice on which you should rely as being factually accurate. Full information which may be relevant to your decision regarding the property can be found on the property listing on carterjonas.co.uk or, (including off market properties) on the brochure or a separately available material information sheet. We would advise you to confirm the details of any material information prior to any offer being submitted. You should not assume that the property has all necessary planning, building regulations or other consents and Carter Jonas has not tested any services, facilities or equipment. Any measurements and distances given are approximate only. Where Carter Jonas has been provided with a floorplan by a third party, we cannot guarantee that the floorplan has been measured in accordance with IPMS. Purchasers must satisfy themselves of all of the aforementioned by independent inspection or otherwise. Our images only represent part of the property as it appeared at the time they were taken and do not represent the furnishings included; these are confirmed in a separate inventory. If you require further information, please contact us.