



**MANCHESTER STREET, LONDON, W1U**  
£750 per week\*

**Carter Jonas**



## FLAT 2, MANCHESTER STREET, LONDON, W1U 7LQ

- Complimentary membership to Portman Concierge.
- Professionally managed by The Portman Estate.
- 1 Bedroom
- 1 Bathroom
- High Ceilings
- Modern
- Great Location
- Ground Floor
- Unfurnished or furnished at extra cost

### THE PROPERTY

This spacious apartment has high ceilings and original features, and comprises a living room, large eat-in kitchen, double bedroom and bathroom.

The property is professionally managed by The Portman Estate.

Available for long term rental on an unfurnished basis, or furnished (at separate cost)

Complimentary membership to Portman Concierge.

Manchester Street is conveniently located in the heart of Marylebone Village, just off Manchester Square. It is only a short distance from the restaurants, shops, and attractions of Marylebone and the West End, as well as outdoor spaces of Hyde Park, Regent's Park, and Manchester Square. Transport links are excellent from nearby Bond Street (about 0.5 mile) and Baker Street (about 0.3 mile) underground stations, as well as Marylebone (about 0.6 mile), Paddington (about 1.1 mile), and Euston (about 1.3 mile) mainline stations.

The Portman Estate is a prestigious property portfolio located in the heart of central London, covering 110 acres of prime real estate in Marylebone. Renting through The Portman Estate comes with the advantage of an in-house property management team, providing responsive, hands-on service to ensure residents' needs are met quickly and efficiently. This dedicated team helps maintain the quality of living, handling everything from routine maintenance to emergency repairs, making the rental experience hassle-free.

Charming one bedroom apartment with impressive high ceilings, set on the ground floor of a Georgian townhouse moments from all the shops & restaurants of Marylebone High Street.





Holding deposit is 1 week's rent = £750 (at asking price)

Security deposit is 5 week's rent = £3,750 (at asking price £750pw)

Minimum term 12 months

Council Tax Band E

For the latest information on broadband and mobile coverage, please visit [/checker.ofcom](#) for the most up-to-date details.

**ADDITIONAL INFORMATION**

Offers	Available for a minimum term of 12 months longer terms will be considered
Viewing	Strictly by appointment
Local Authority	Westminster City Council - Council Tax Band E



## Manchester Street, W1

Approximate Gross Internal Area = 63 sq m / 678 sq ft

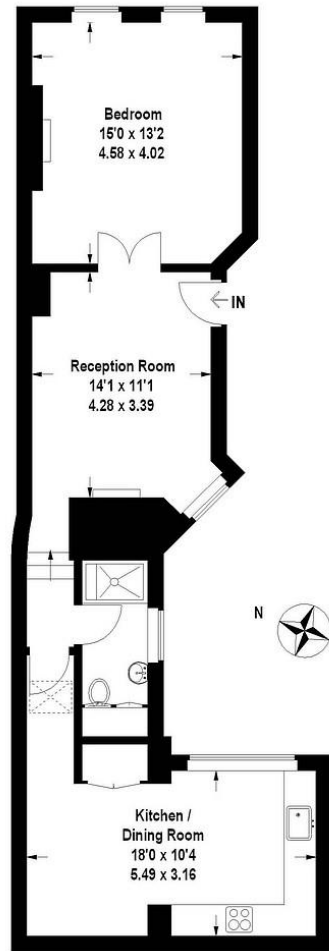

Ground Floor

This plan is for layout guidance only. Not drawn to scale unless stated. Windows and door openings are approximate. Whilst every care is taken in the preparation of this plan, please check all dimensions, shapes and compass bearings before making any decisions reliant upon them. (ID56762)

**T: 020 7486 8866**

37 New Cavendish Street, London, W1G 9TL

E: [marylebone.lettings@carterjonas.co.uk](mailto:marylebone.lettings@carterjonas.co.uk)

A member of



Energy Efficiency Rating		
	Current	Potential
Very energy efficient - lower running costs		
(92-100) <b>A</b>		
(81-91) <b>B</b>		
(69-80) <b>C</b>		
(55-68) <b>D</b>	64	66
(39-54) <b>E</b>		
(21-38) <b>F</b>		
(1-20) <b>G</b>		
Not energy efficient - higher running costs		
England, Scotland & Wales	EU Directive 2002/91/EC	

### IMPORTANT INFORMATION

These particulars are for general information purposes only and do not represent an offer or contract or part of one. Carter Jonas or anyone in their employment has made every attempt to ensure that the particulars and other information provided are as accurate as possible and they are not intended to amount to advice on which you should rely as being factually accurate. Full information which may be relevant to your decision regarding the property can be found on the property listing on [carterjonas.co.uk](http://carterjonas.co.uk) or a separately available material information sheet, and we would advise you to confirm the details of any material information prior to any offer being submitted. You should not assume that the property has all necessary planning, building regulations or other consents and Carter Jonas has not tested any services, facilities, or equipment. Any measurements and distances given are approximate only. Where Carter Jonas has been provided with a floorplan by a third party, we cannot guarantee that the floorplan has been measured in accordance with IPMS. Purchasers or prospective tenants must satisfy themselves of all of the aforementioned by independent inspection or otherwise. Our images only represent part of the property as it appeared at the time they were taken and do not represent the furnishings included; these are confirmed in a separate inventory. If you require further information, please contact us. \*Administration fees may apply depending on tenancy type. Please contact your local branch for this information.