



WHEATLEY STREET, MARYLEBONE
£5,200 per month*

Carter Jonas

WHEATLEY STREET, MARYLEBONE, LONDON, W1G 8PS

Beautiful maisonette situated on a quiet street just moments from Marylebone High Street and within easy reach of transport links.

- Two bedroom maisonette
- Large reception room with double aspect windows
- Two spacious bathrooms
- Plenty of storage throughout
- Unfurnished or furnished at additional costs
- Located close to Marylebone High Street

LOCATION

Nestled in the heart of Marylebone, Wheatley Street offers an exceptional blend of classic London charm and modern convenience. This vibrant location boasts easy access to boutique shops, renowned restaurants, and excellent transport links, including nearby Bond Street and Oxford Circus stations. Ideal for professionals seeking a stylish, well-connected home in one of London's most desirable neighbourhoods.

THE PROPERTY

*The property has been redecorated since these photos were taken

This maisonette is set over two floors and comprises of an open plan kitchen and reception room, two double bedrooms with fitted storage and two bathrooms.

The property benefits from lots of natural light, wooden flooring and access of a communal courtyard.

Holding deposit is 1 weeks rent = £1,200 (at asking price)

Security deposit is 6 weeks rent = £7,200 (at asking price)

Council Tax Band G



ADDITIONAL INFORMATION

Offers	Available for a minimum term of 12 months longer terms will be considered
Viewing	Strictly by appointment
Local Authority	Westminster City Council - Council Tax Band G
Info	<p>For eligibility for resident parking permits, please refer to the https://www.westminster.gov.uk/parking website for further details.</p> <p>For the latest information on broadband and mobile coverage, please visit https://checker.ofcom.org.uk/engb/broadband-coverage for the most up-to-date details.</p>

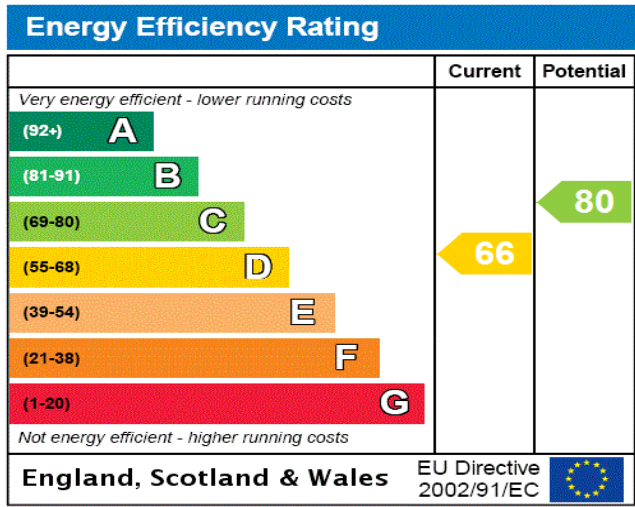

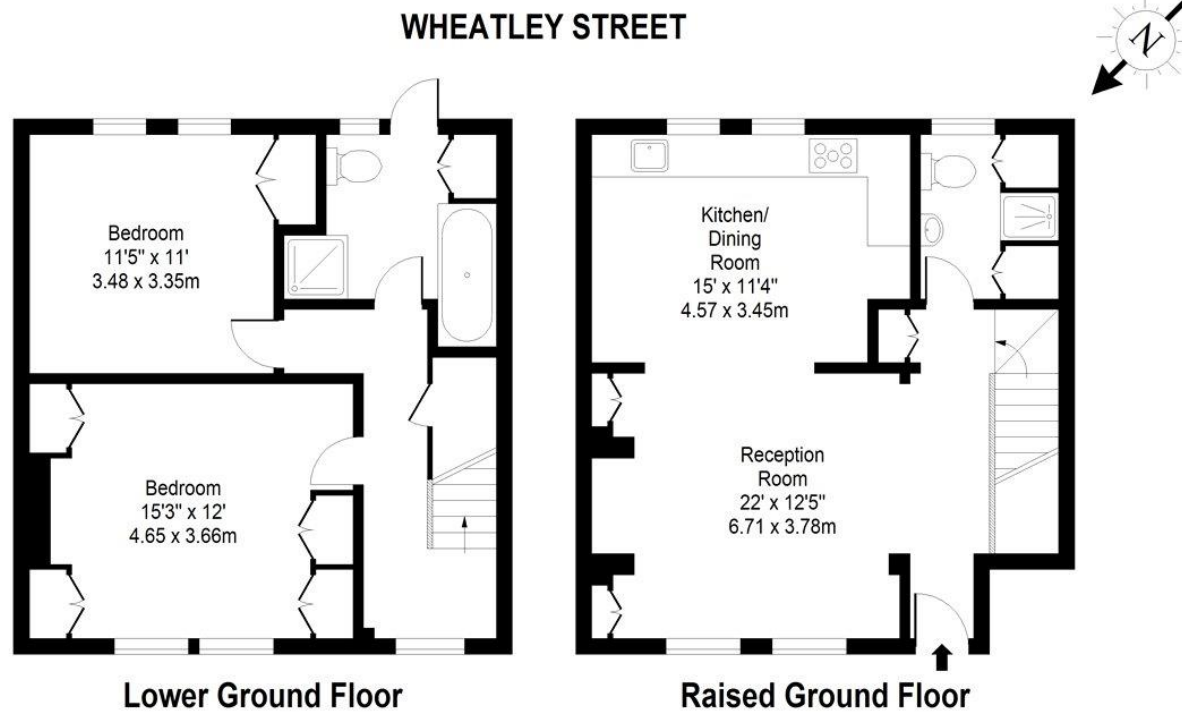

Approx. Gross Internal Area 1050 Sq Ft - 95.69 Sq M
For Illustrative Purposes Only - Not To Scale
www.lpaplus.com



T: 020 7486 8866

37 New Cavendish Street, London, W1G 9TL

E: marylebone.lettings@carterjonas.co.uk



Exclusive UK affiliate of

CHRISTIE'S
INTERNATIONAL REAL ESTATE

Classification L2 - Business Data

IMPORTANT INFORMATION

These particulars are for general information purposes only and do not represent an offer or contract or part of one. Carter Jonas or anyone in their employment has made every attempt to ensure that the particulars and other information provided are as accurate as possible and they are not intended to amount to advice on which you should rely as being factually accurate. Full information which may be relevant to your decision regarding the property can be found on the property listing on carterjonas.co.uk or a separately available material information sheet, and we would advise you to confirm the details of any material information prior to any offer being submitted. You should not assume that the property has all necessary planning, building regulations or other consents and Carter Jonas has not tested any services, facilities, or equipment. Any measurements and distances given are approximate only. Where Carter Jonas has been provided with a floorplan by a third party, we cannot guarantee that the floorplan has been measured in accordance with IPMS. Purchasers or prospective tenants must satisfy themselves of all of the aforementioned by independent inspection or otherwise. Our images only represent part of the property as it appeared at the time they were taken and do not represent the furnishings included; these are confirmed in a separate inventory. If you require further information, please contact us. *Administration fees may apply depending on tenancy type. Please contact your local branch for this information.