



HARBORD STREET, LONDON, SW6
£3,000 per month*

Carter Jonas

HARBORD STREET, LONDON, SW6

- Three bedrooms
- Two bathrooms
- Furnished
- Sharers considered
- Moments from Bishops Park
- Fully fitted kitchen

THE PROPERTY

This furnished first and second floor flat comprises of two double bedrooms and one single bedroom. There is a spacious reception room on the first floor along with a fully equipped kitchen and a bathroom. The top floor comprises of a large double bedroom with an en-suite bathroom. There is good storage space throughout.

Sharers considered.

The property benefits from its own private entrance, and on street parking is available.

LOCATION

Harbord Street is a popular residential street in the Bishops Park conservation area with Bishops Park and leafy riverside walks nearby. Putney Bridge tube station is within easy walking distance as are the good local shops and restaurants of Fulham Road, Munster Road and Fulham Palace Road.

A delightful first and second floor apartment located on a quiet and residential street, moments from Bishops Park and convenient transport links. EPC Grade: E



Holding deposit: 1 week's rent

Security deposit: 5 week's rent

Council tax band: F

ADDITIONAL INFORMATION

Offers	Available for a minimum term of 12 months Longer terms will be considered
Viewing	Strictly by appointment
Local Authority	Hammersmith and Fulham Council Tax Band F



Harbord Street,
Fulham, SW6

Approximate Area = 99.12 sq m / 1067 sq ft

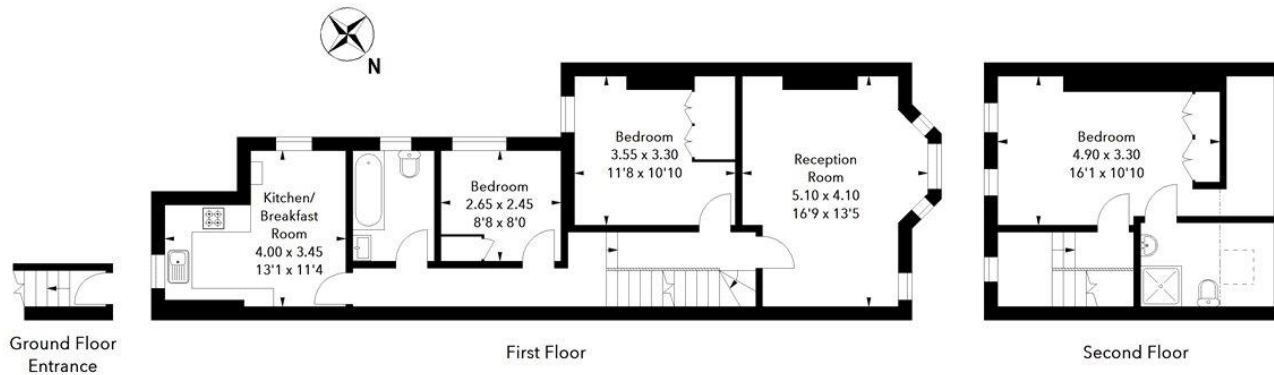

The floor plan is not to scale and measurements and areas shown are approximate and therefore should be used for illustrative purposes only. The plan has been prepared in accordance with the RICS code of Measuring Practice and whilst we have confidence in the information produced, it must not be relied on. If there is any aspect of particular importance, you should carry out or commission your own inspection of the property.

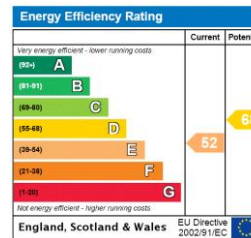

T: 020 7751 8898

361 Fulham Palace Road, London, SW6 6TA

E: fulhamlettings@carterjonas.co.uk



Exclusive UK affiliate of

CHRISTIE'S
INTERNATIONAL REAL ESTATE

Classification L2 - Business Data

IMPORTANT INFORMATION

These particulars are for general information purposes only and do not represent an offer or contract or part of one. Carter Jonas or anyone in their employment has made every attempt to ensure that the particulars and other information provided are as accurate as possible and they are not intended to amount to advice on which you should rely as being factually accurate. Full information which may be relevant to your decision regarding the property can be found on the property listing on carterjonas.co.uk or a separately available material information sheet, and we would advise you to confirm the details of any material information prior to any offer being submitted. You should not assume that the property has all necessary planning, building regulations or other consents and Carter Jonas has not tested any services, facilities, or equipment. Any measurements and distances given are approximate only. Where Carter Jonas has been provided with a floorplan by a third party, we cannot guarantee that the floorplan has been measured in accordance with IPMS. Purchasers or prospective tenants must satisfy themselves of all of the aforementioned by independent inspection or otherwise. Our images only represent part of the property as it appeared at the time they were taken and do not represent the furnishings included; these are confirmed in a separate inventory. If you require further information, please contact us. *Administration fees may apply depending on tenancy type. Please contact your local branch for this information.