



**BROOKWOOD ROAD, LONDON, SW18**

£1,250 per month\*

**Carter Jonas**

---

## GROUND FLOOR FLAT, BROOKWOOD ROAD, LONDON, SW18 5BY

Charming studio apartment set within an attractive Victorian conversion, and close to Southfields Underground (0.3 miles).

- 0.3 miles to Southfields Tube
- Unfurnished
- Studio Apartment
- Separate Bathroom and Kitchen

### THE PROPERTY

Located on the sought-after Brookwood Road, this charming studio apartment is set within an attractive Victorian conversion and offers well-proportioned living space on the ground floor.

Neutrally decorated throughout, the property features a spacious studio room with ample space for both living and sleeping areas, a separate modern bathroom, and a well-equipped kitchen complete with a brand-new oven.

Perfectly positioned just a short walk (0.3 miles) from Southfields Underground Station (District Line), the property offers excellent access to local shops, cafés, and the green open spaces of Wimbledon Park.





# ADDITIONAL INFORMATION

Offers	Available for a minimum term of 12 months longer terms will be considered
Viewing	Strictly by appointment
Local Authority	London Borough of Wandsworth - Council Tax Band B

EPC Rating: D  
Council tax band: B (refer to Wandsworth Council's website for current cost).  
Available for a minimum term of 12 months Mains gas central heating, mains electric & mains water.  
Internet: Ultrafast internet available  
Mobile signal: O2 and Vodafone (indoors & outdoors), EE and Three (outdoors)  
Further information on internet and mobile availability and speeds can be found on Ofcom's website.  
At a rent of £1,250 per month  
Holding deposit of 1 weeks rent at £288.46  
Security deposit of 5 weeks rent at £1442.30



# Brookwood Road, SW18

Approximate Area = 21.37 sq m / 230 sq ft

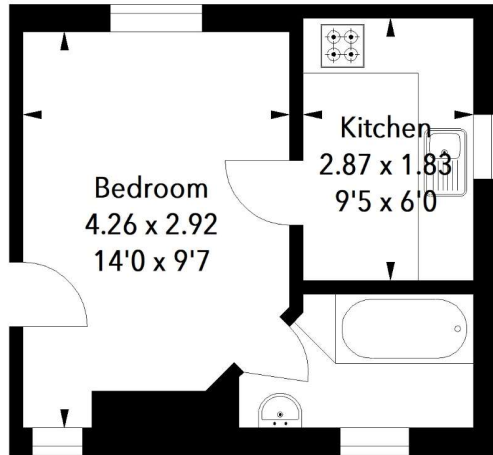

Ground Floor

Key :  
CH - Ceiling Height



The floor plan is not to scale and measurements and areas shown are approximate and therefore should be used for illustrative purposes only. The plan has been prepared in accordance with the RICS code of Measuring Practice and whilst we have confidence in the information produced, it must not be relied upon. If there is any aspect of particular importance, you should carry out or commission your own inspection of the property.

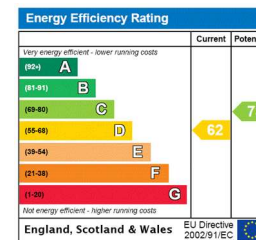

T:  
24 Replingham Road, London, SW18 5LR  
E: [sou.res.lets@carterjonas.co.uk](mailto:sou.res.lets@carterjonas.co.uk)



Exclusive UK affiliate of  
**CHRISTIE'S**  
INTERNATIONAL REAL ESTATE

Classification L2 - Business Data

## IMPORTANT INFORMATION

These particulars are for general information purposes only and do not represent an offer or contract or part of one. Carter Jonas or anyone in their employment has made every attempt to ensure that the particulars and other information provided are as accurate as possible and they are not intended to amount to advice on which you should rely as being factually accurate. Full information which may be relevant to your decision regarding the property can be found on the property listing on [carterjonas.co.uk](http://carterjonas.co.uk) or a separately available material information sheet, and we would advise you to confirm the details of any material information prior to any offer being submitted. You should not assume that the property has all necessary planning, building regulations or other consents and Carter Jonas has not tested any services, facilities, or equipment. Any measurements and distances given are approximate only. Where Carter Jonas has been provided with a floorplan by a third party, we cannot guarantee that the floorplan has been measured in accordance with IPMS. Purchasers or prospective tenants must satisfy themselves of all of the aforementioned by independent inspection or otherwise. Our images only represent part of the property as it appeared at the time they were taken and do not represent the furnishings included; these are confirmed in a separate inventory. If you require further information, please contact us. \*Administration fees may apply depending on tenancy type. Please contact your local branch for this information.